

- Mercury single with 10mm bundle adaptor (B10) is for [10mm diameter multi-core fibers](#).

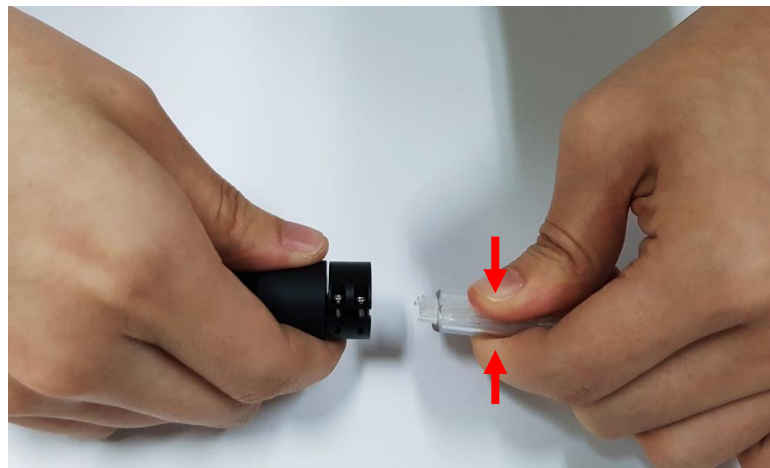

10mm multi-core POF and Mercury-R/G/B-B10

- How to assemble POF into Mercury-R/G/B-B10
 - Press POF up and down to assemble POF into the Bundle adaptor.
 - Place POF horizontally to insert into the Bundle adaptor.

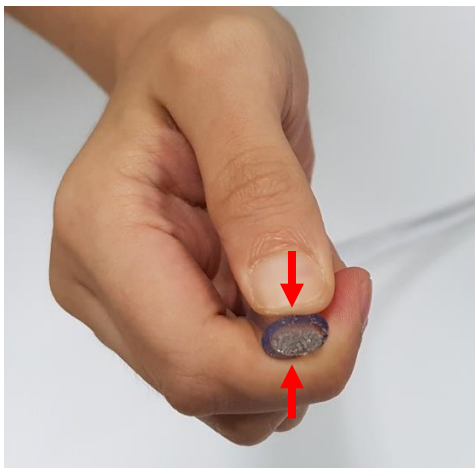

3. Push POF to the end into the Bundle adaptor.



4. Lock the M1.6 screw of the bundle adaptor by turning it with a screwdriver so that POF does not come off.



Example of incorrect assembly(POF inserted into only middle)